

# Birlea

Suppliers of inspiration

## Assembly Instructions

---

*Thank you for  
purchasing a  
Birlea product.*

For a chance to win a *Love 2 Shop* voucher simply post a picture of your new product on your preferred social channels tagging Birlea Furniture and using the hashtag **#ShareYourStyle** and **#Birlea**. One winner will be selected at random each month.

*To view our full terms and conditions please visit our website. [www.birlea.com](http://www.birlea.com)*

---

### Are you happy with your purchase?

**Yes:** That's great, we would love to hear more from you. Please leave us a review on our social media channels or Trustpilot. Your feedback will be greatly appreciated.

**No:** If for any reason there is something missing, indifferent or incorrect with your order, please contact the retailer you purchased the item from. We will work with the retailer to resolve your issue as quickly as possible.



[www.birlea.com](http://www.birlea.com)

## **ASSEMBLY INSTRUCTIONS** **URBAN LARGE SIDBOARD RUSTIC**

**IMPORTANT : READ THESE INSTRUCTIONS CAREFULLY BEFORE ATTEMPTING TO ASSEMBLE OR USE YOUR URBAN LARGE DRAWER RUSTIC.**

**PLEASE KEEP THESE INSTRUCTIONS FOR FUTURE REFERENCE.**

### **ASSEMBLY:**

Assembly should be carried out with this item laying flat, not standing upright.

Assemble on a soft, clean surface to prevent damages.

To erase the numbers printed on the pieces, use the rubber inside the accessories pack.

### **HEALTH & SAFETY:**

DO NOT use this product if any parts are missing, damaged or worn.

DO NOT use this product unless all fixings are secured.

Always use on a level, even surface.

### **CARE & MAINTENANCE:**

Periodically check all screws & fixings to ensure they are secure.

DO NOT push this product as this will cause damage.

Always lift this product with two people to repositions.

Keep any sharp objects away from this product.

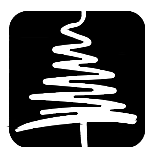
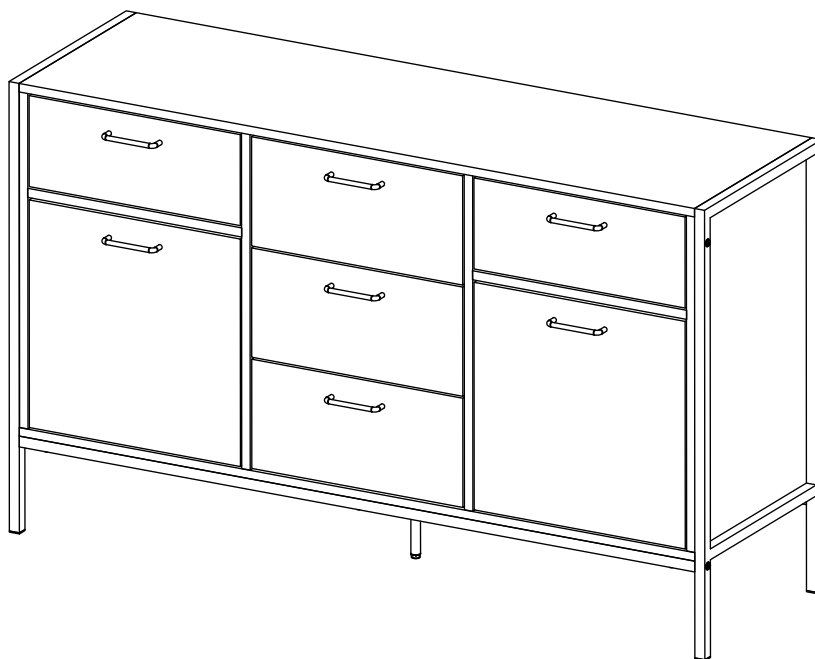

**Birlea**

Suppliers of inspiration

[www.birlea.com](http://www.birlea.com)

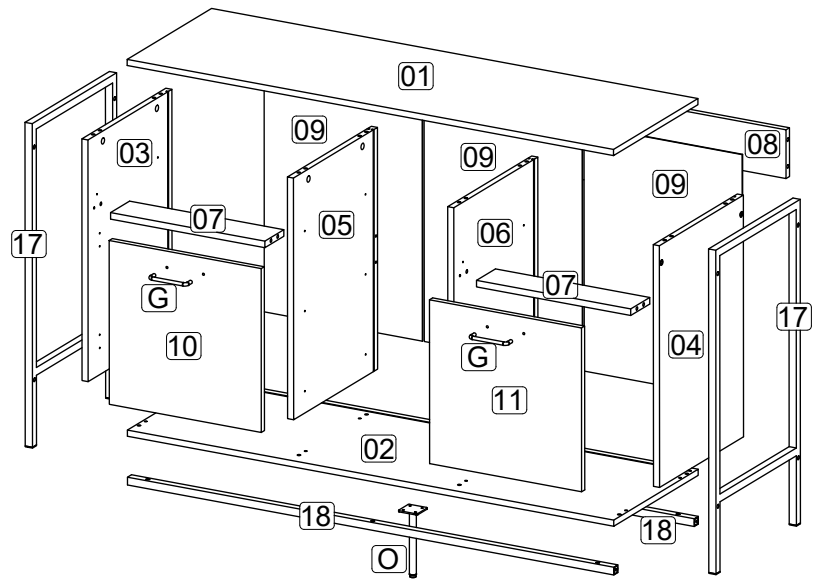
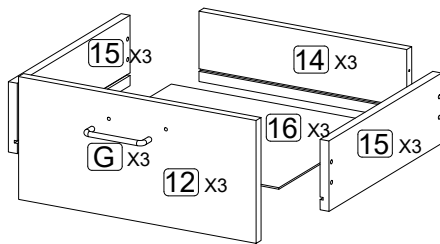
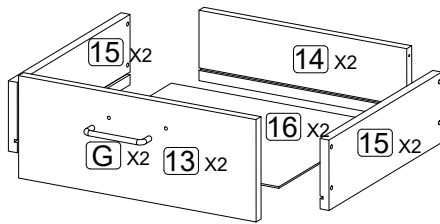
**Parts List**

Part	Description	Box	Qty
01	Top panel	1	1
02	Bottom panel	1	1
03	Side panel (Left)	1	1
04	Side panel ( Right )	1	1
05	Center panel (Left)	1	1
06	Center panel (Right)	1	1
07	Bone panel	2	2
08	Back bone	2	1
09	Back panel	2	3
10	Door panel (Left)	2	1
11	Door panel (Right)	2	1
12	Drawer front	2	3
13	Drawer front (Left & Right)	2	2
14	Drawer back	1	4
		2	1
15	Drawer side	1	10
16	Drawer bottom	2	5
17	Metal Side ( Left & Right )	1	2
18	Metal middle	1	2

**Hardware List ( BOX 2 )**

Part	Description	Qty
A1	Cam lock	16
A2	Minifix screw	16
A3	Plastic cap	16
B	M8 x 30mm Wood Dowel	20
C	M6 x 50mm CSK Cap Wood screw	8
D	M3.5 x 16mm C.B Screw	82
E	M4 x 38mm C.B Screw	40
F	Allen key M4	1
G	Handle 100.96. BLM	7
H	Handle screw M4 x 19mm	14
I	JCBC screw M6 x 30mm	10
J	JCBC screw M6 x 40mm	4
K1	Stud 192	8
K2	Stud 192 screw	8
L	Drawer stopper ( 2 Pin )	2
M	7/8 Hinges	4
N1	14" Drawer slide (Left / Right)	10
N2	14" Drawer slide (Left / Right)	10
O	Metal leg center	1
P	8" x 1" PP tape	2
Q	Wall plug	-

**\*\* You will need a small mallet and a screwdriver for assembly.**

**\*\* Some screws and wooden dowel may remain.**

**\*\* Note : To secure the item to the wall, hardware E ( 2 pcs ) and Q ( 2 pcs ) are not provided.**

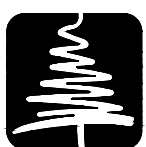

# Birlea

Suppliers of inspiration

**Step 1:** Insert hardware parts A1, A2, B, D, F, G, H, L, M and N1 into part (1),(3),(4),(5),(6),(7),(8),(10),(11),(12),(13) like the below.

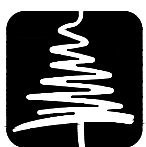
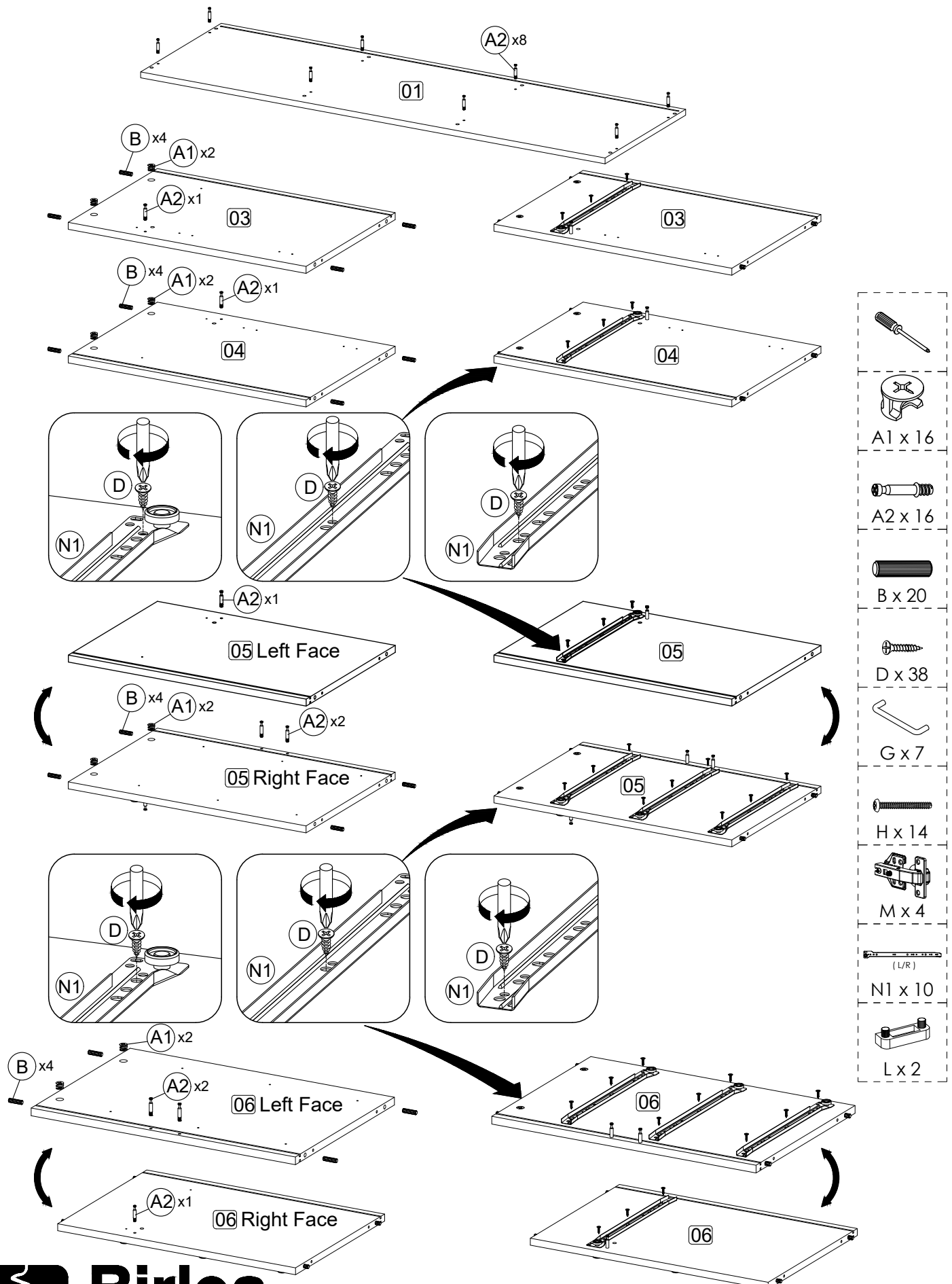

**Birlea**  
Suppliers of inspiration

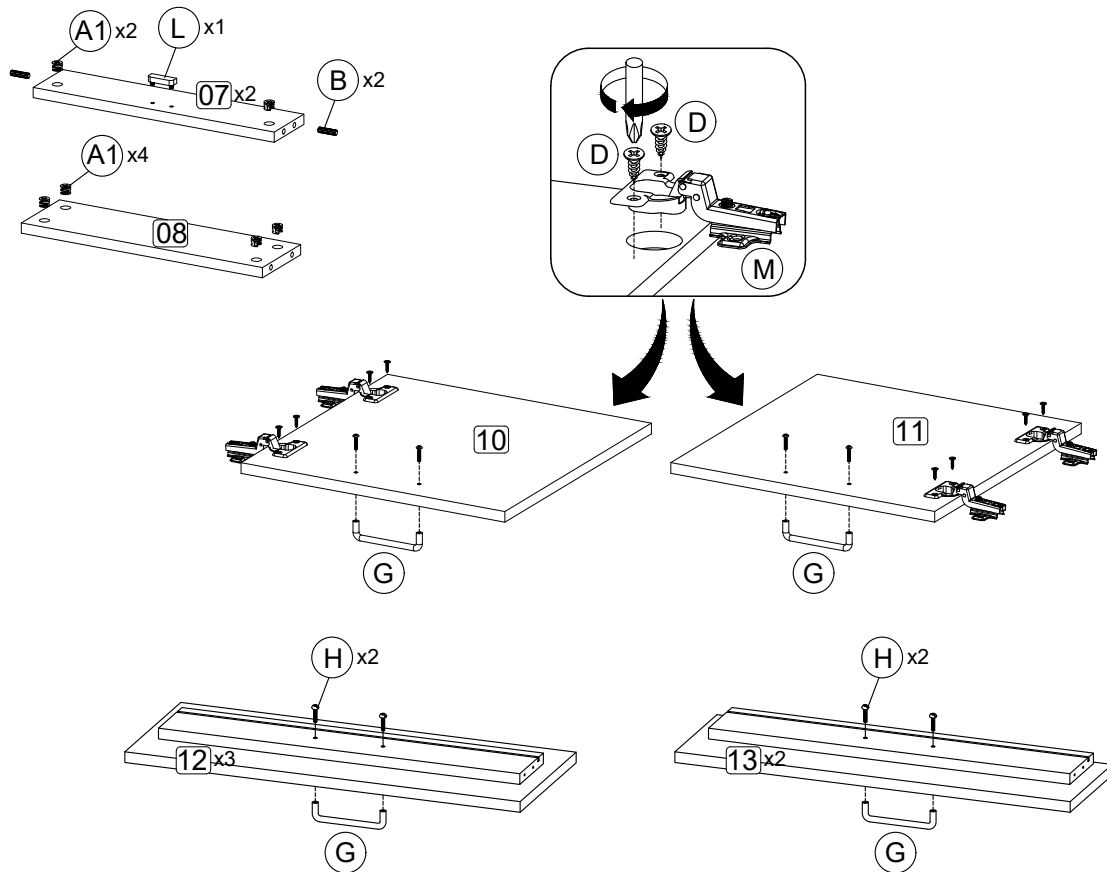

**Step 2:** Attach center panel left (5) and center panel right (6) to back bone (8) using hardware A1 and A2 with a screwdriver (not provided).

**DO NOT use any power tools as this may damage the frame and will invalidate any claim.**

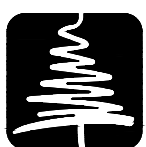
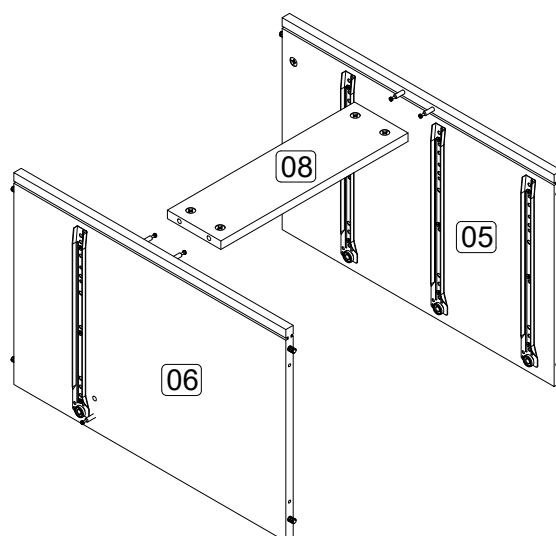
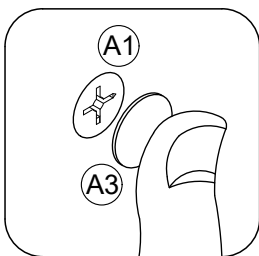
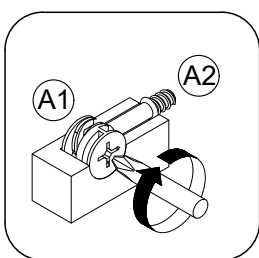
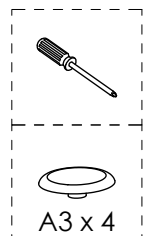

**Step 3:** Attach side panel (3) and side panel (4) to bone panel (7) using hardware A1 and A2 with a screwdriver (not provided).

**DO NOT use any power tools as this may damage the frame and will invalidate any claim.**

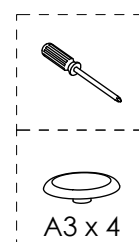
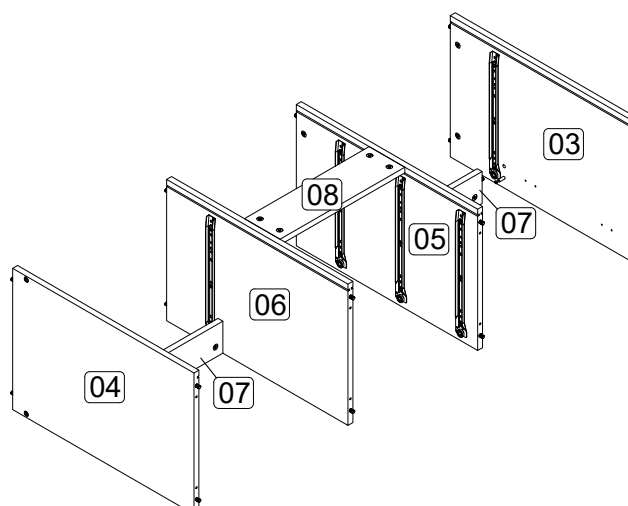
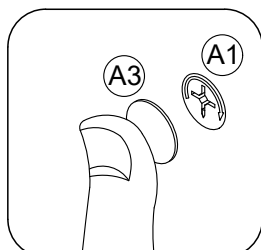
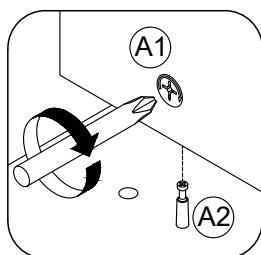

**Step 4:** Attach side panel (3), side panel (4), center panel (Left) (5), center panel (right) (6) to top panel (1) using hardware A1 and A2 with a screwdriver (not provided).

**DO NOT use any power tools as this may damage the frame and will invalidate any claim.**

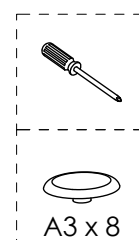
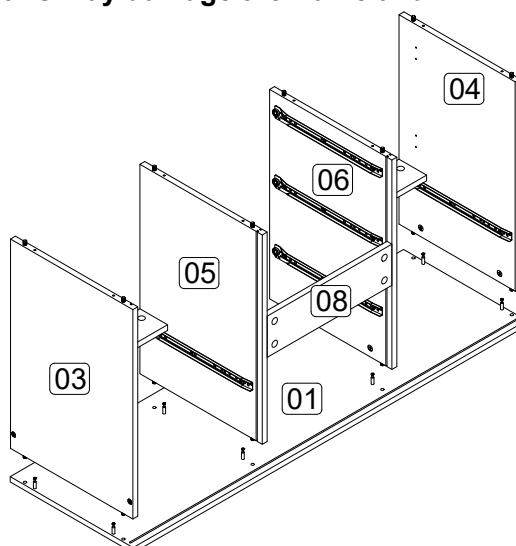
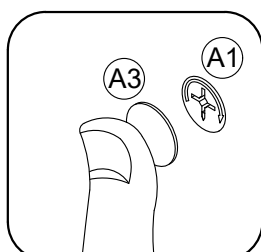
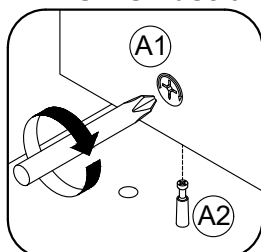

**Step 5:** Insert back panel (9) along the slot.

**DO NOT use any power tools as this may damage the frame and will invalidate any claim.**

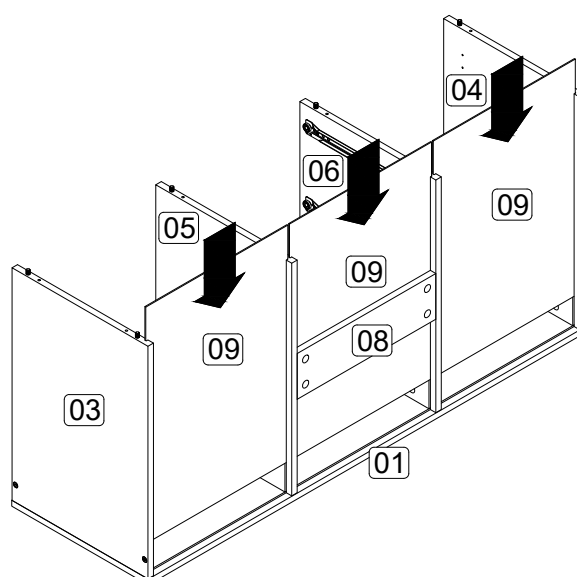

**Birlea**

Suppliers of inspiration

**Step 6:** Attach bottom panel (2) to side panel (3), side panel (4), center panel (left) (5) and center panel (right) (6) using hardware C and F.

**DO NOT use any power tools as this may damage the frame and will invalidate any claim.**

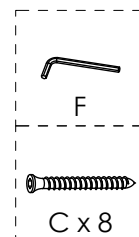
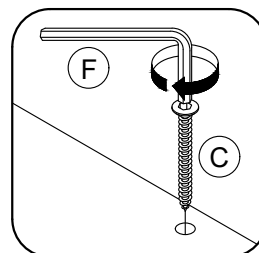
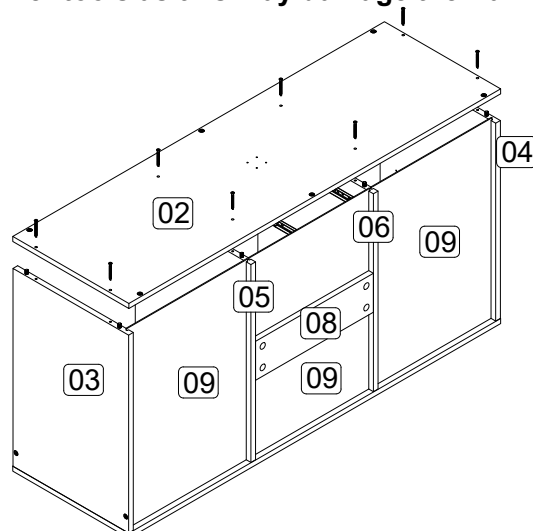

**Step 7:** Attach hardware K1 into top panel (1), bottom panel (2), side panel (3) and (4) using hardware K2 with a screwdriver (not provided).

**DO NOT use any power tools as this may damage the frame and will invalidate any claim.**

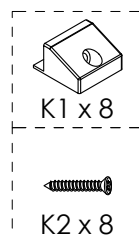
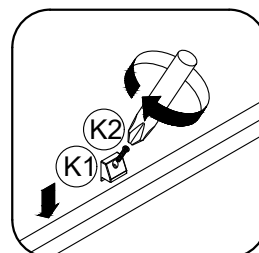
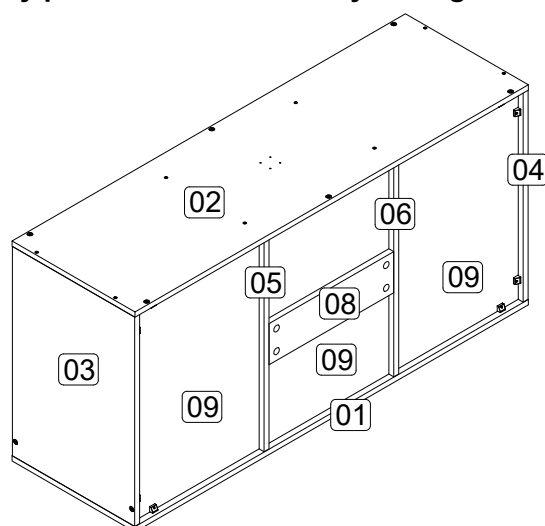

**Step 8:** Attach metal frame middle (18) to bottom panel (2) using hardware F and I.

Attach metal leg center (O) to bottom panel (2) using hardware D.

**DO NOT use any power tools as this may damage the frame and will invalidate any claim.**

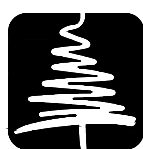
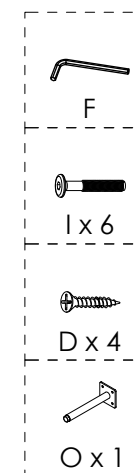
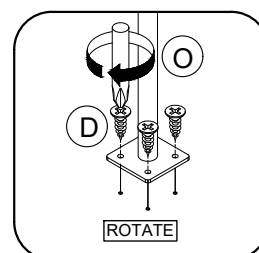
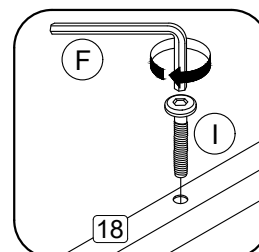
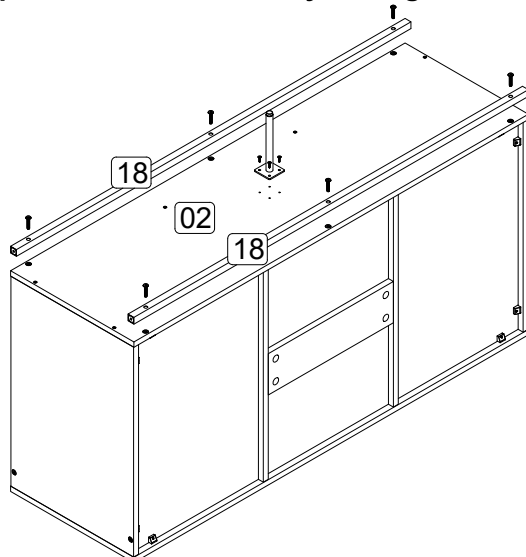

**Birlea**

Suppliers of inspiration

**Step 9:** Attach metal frame side (17) to side panel (3) and (4) using hardware F and I.  
 Attach metal frame side (17) to metal frame middle (18) using hardware F and J.  
**DO NOT use any power tools as this may damage the frame and will invalidate any claim.**

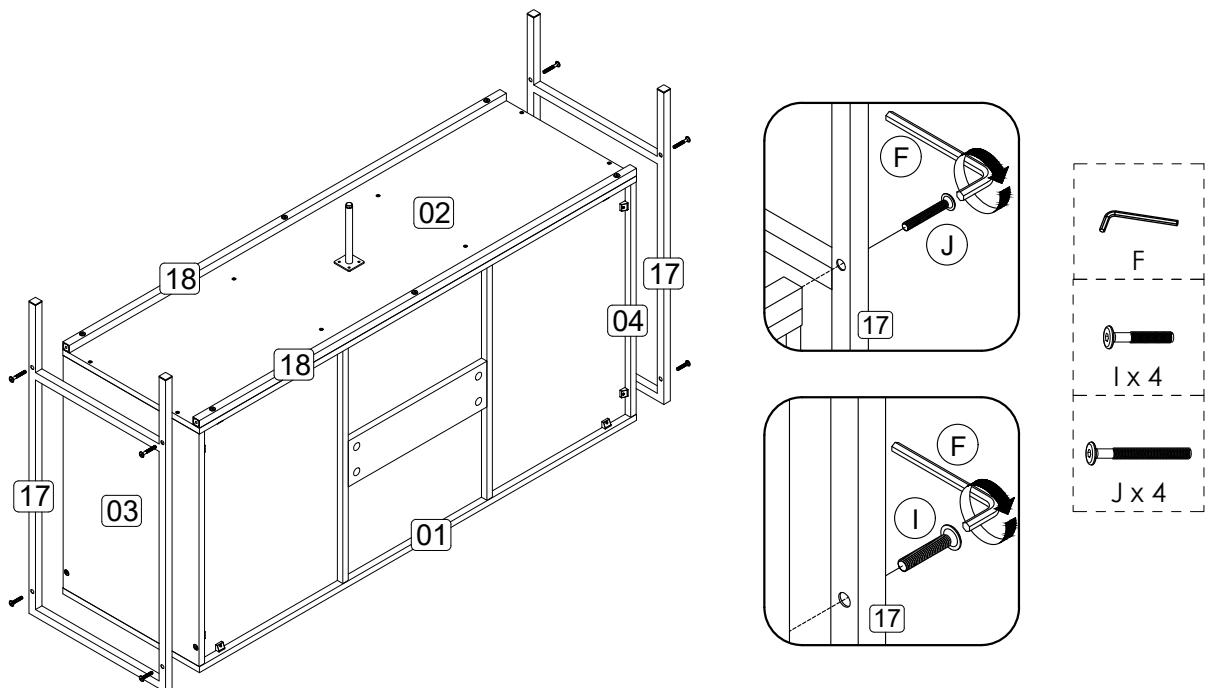

**Step 10:** Attach door panel (10) to side panel (3) and door panel (11) to side panel (4) using hardware D with a screwdriver (not provided).  
**DO NOT use any power tools as this may damage the frame and will invalidate any claim.**

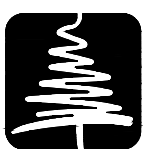
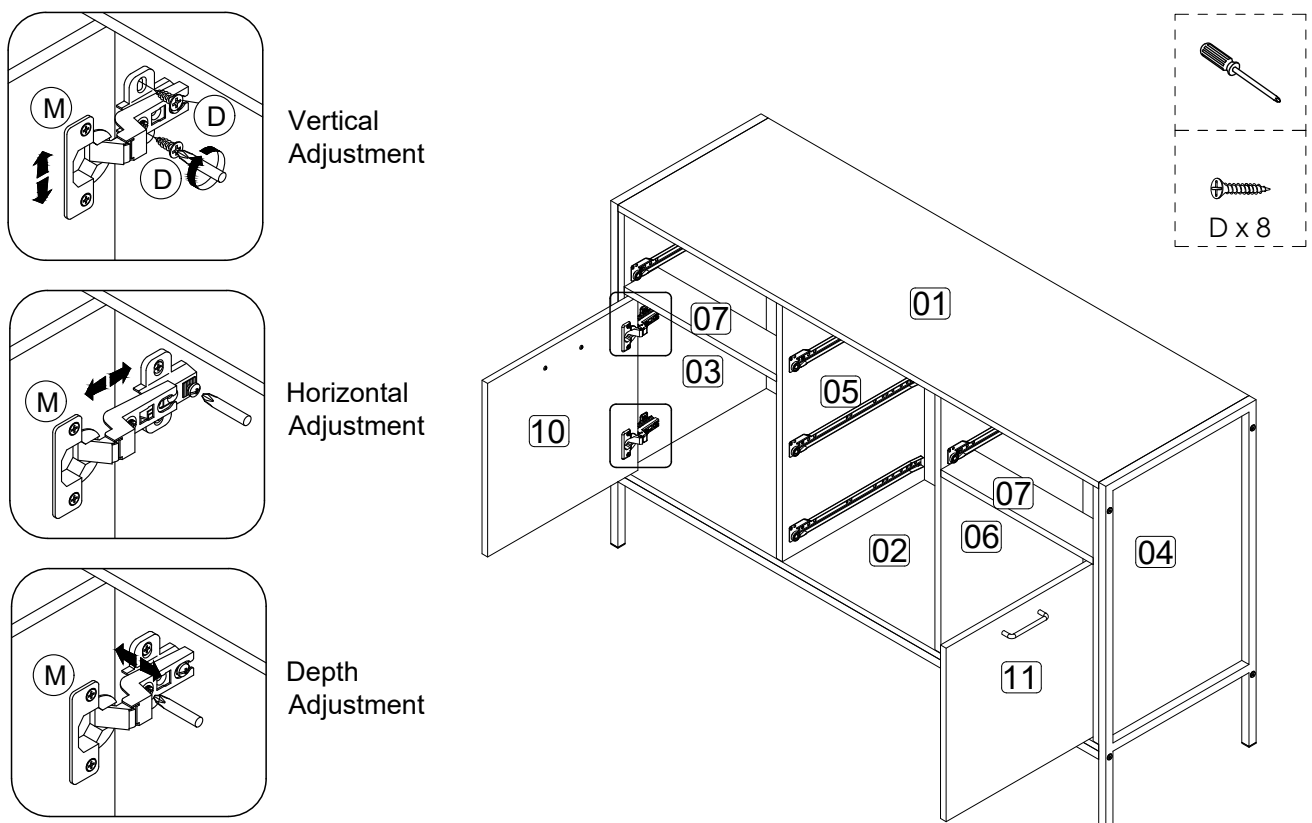

# Birlea

Suppliers of inspiration



- Step 11:** 1. Attach the drawer side (15) to the drawer back (14) and drawer front (12) using hardware part (E).  
 2. Slide in the drawer bottom (16) then attach the drawer side (15) using hardware part (E).  
 3. Attach the hardware part (N2) to the drawer sides (15) using hardware part (D).

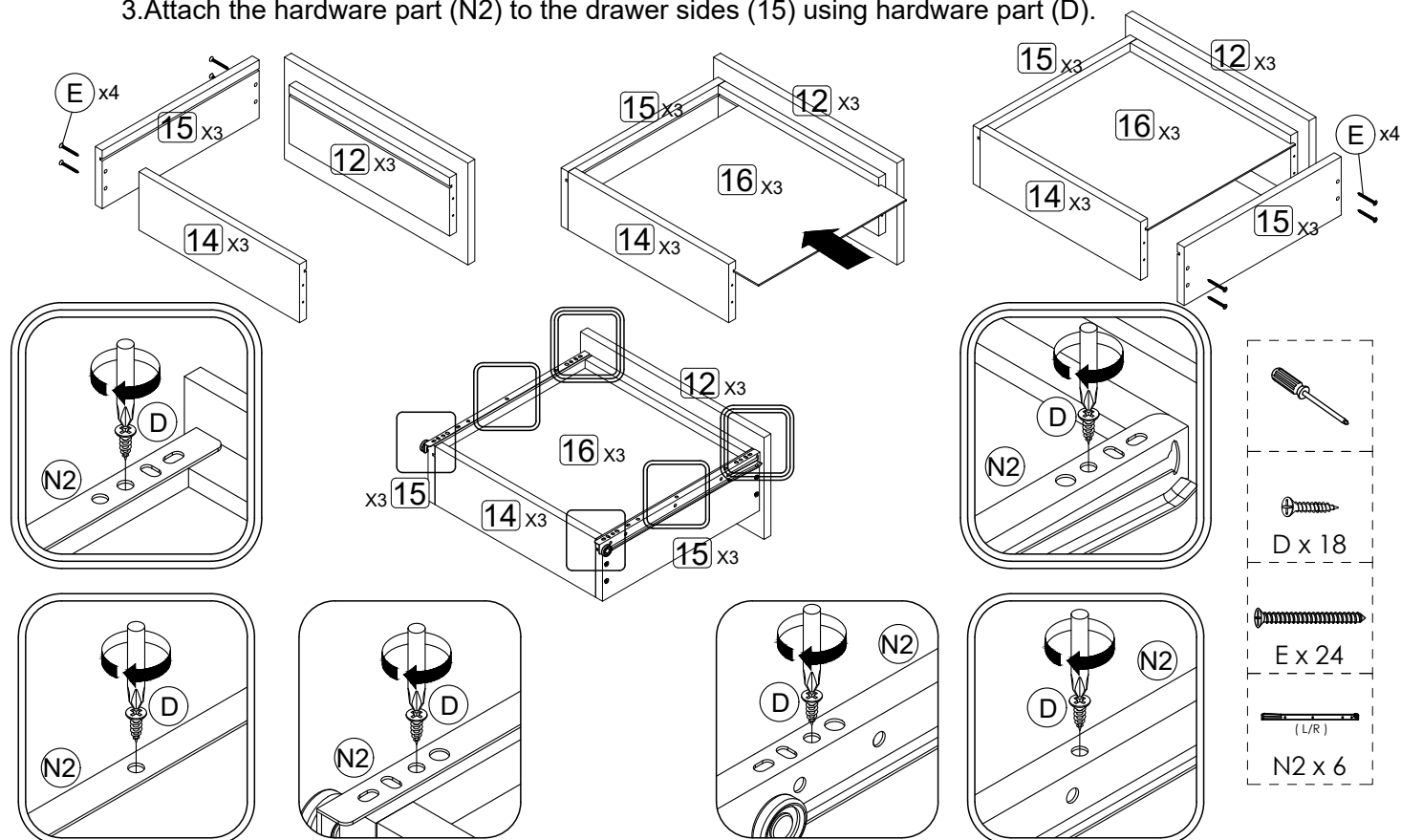

- Step 12:** 1. Attach the drawer side (15) to the drawer back (14) and the drawer front (13) using hardware part (E).  
 2. Slide in the drawer bottom (16) then attach the drawer side (15) using hardware part (E).  
 3. Attach the hardware part (N2) to the drawer sides (15) using hardware part (D).

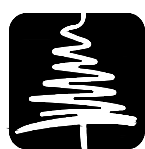
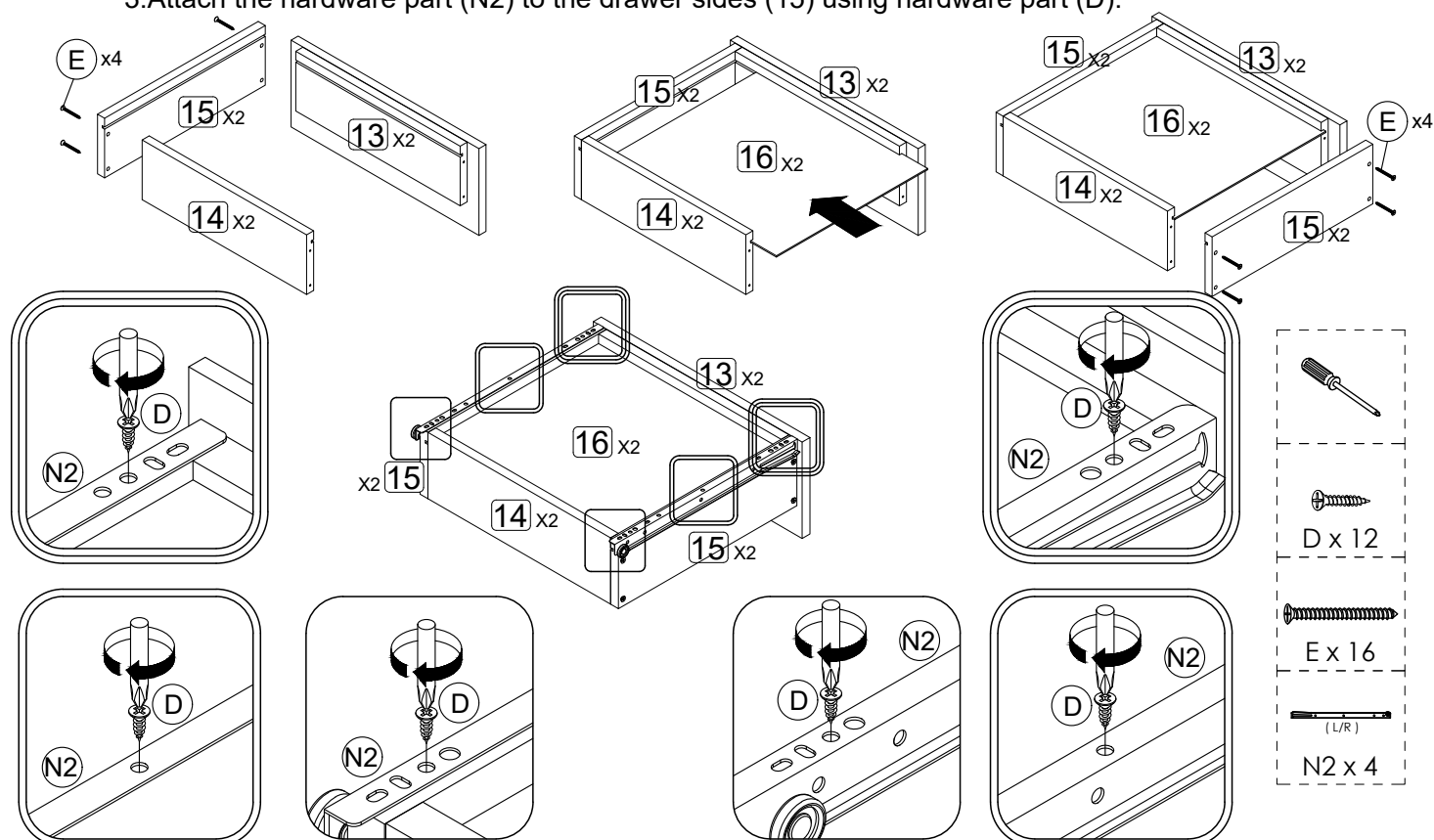

# Birlea

Suppliers of inspiration

**Step 13:** Assemble the drawer in place along the drawer slides.

**DO NOT use any power tools as this may damage the frame and will invalidate any claim.**

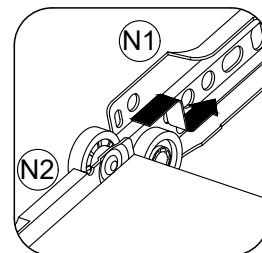
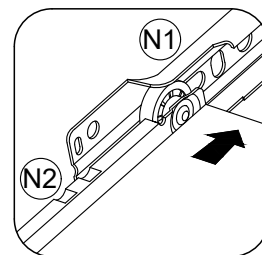
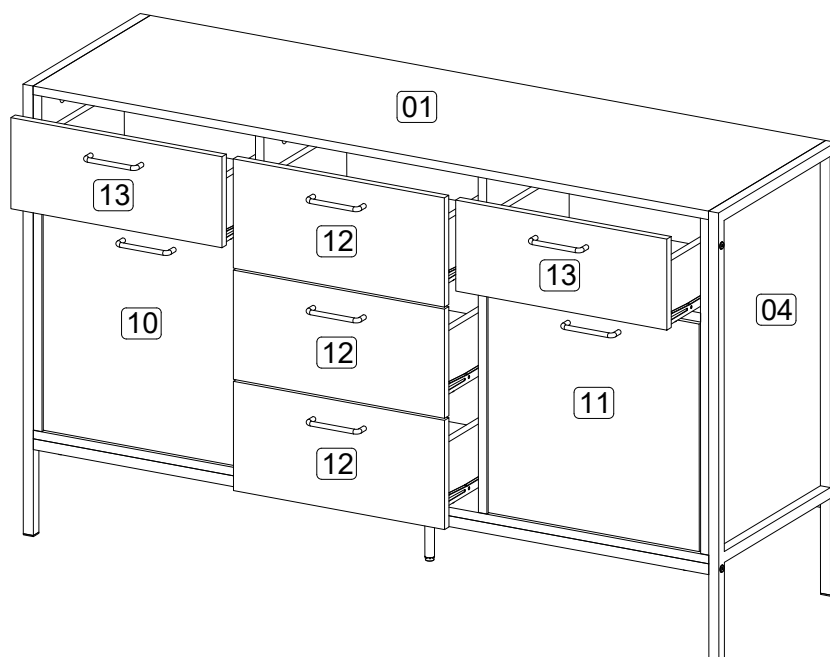

**Step 14:** To secure the item to the wall use hardware E, P and Q using a screwdriver (not provided).

Then attach hardware part P to top panel (1) using hardware D with a screwdriver (not provided).

**DO NOT use any power tools as this may damage the frame and will invalidate any claim.**

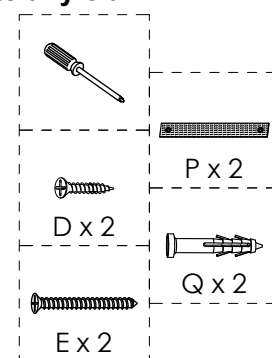
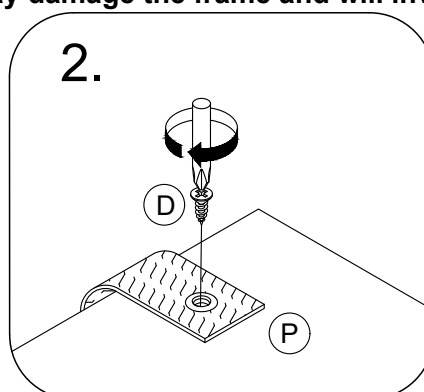
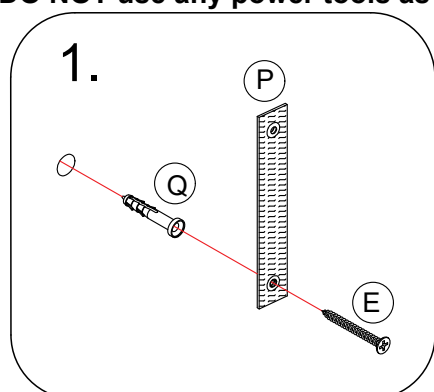

**PLEASE NOTE** that wall fixings are not supplied as different wall materials require different fixing devices. You must use fixings devices suitable for the type of wall you intend to mount product to. Ensure the head of any screw used has a diameter greater than the mounting hole and the fixing is safe and secure before use.

Birlea Furniture advise you use the hardware P ( 2 pcs ) are provided to further enhance the safety of this product.

### Additional Information:

- For complete product information, images and dimension diagrams please visit the website [www.birlea.com](http://www.birlea.com)
- If you have any issues with your item please contact the retailer directly you purchased it from who will be able to resolve any issues with Birlea.
- Why don't you send us photos of your assembled furniture to [info@birlea.com](mailto:info@birlea.com) to be shared in our #birleahome feature on instagram.

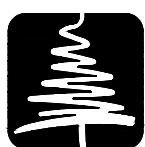

# Birlea

Suppliers of inspiration